

1. **Sealing and Grouting:** Epoxy resin is used to seal the joints between tiles, preventing water and dirt from penetrating. It also provides a strong, durable bond between the tiles and the substrate.

2. **Waterproofing:** Epoxy resin is applied to the walls and floors in bathrooms and kitchens to create a waterproof barrier, preventing moisture from seeping through.

3. **Decorative Finishes:** Epoxy resin can be used to create decorative finishes on walls and floors, such as epoxy resin floors, epoxy resin wall panels, and epoxy resin wall panels.

4. **Repair and Maintenance:** Epoxy resin is used to repair damaged tiles, grout, and walls. It can also be used to clean and restore the appearance of old tiles and grout.

5. **Anti-Slip Surfaces:** Epoxy resin can be used to create anti-slip surfaces on floors, walls, and ceilings, providing a safe and secure environment.

6. **Decorative Wall Panels:** Epoxy resin can be used to create decorative wall panels, such as epoxy resin wall panels, epoxy resin wall panels, and epoxy resin wall panels.

7. **Decorative Floor Panels:** Epoxy resin can be used to create decorative floor panels, such as epoxy resin floor panels, epoxy resin floor panels, and epoxy resin floor panels.

8. **Decorative Ceiling Panels:** Epoxy resin can be used to create decorative ceiling panels, such as epoxy resin ceiling panels, epoxy resin ceiling panels, and epoxy resin ceiling panels.

9. **Decorative Light Fixtures:** Epoxy resin can be used to create decorative light fixtures, such as epoxy resin light fixtures, epoxy resin light fixtures, and epoxy resin light fixtures.

10. **Decorative Wall Panels:** Epoxy resin can be used to create decorative wall panels, such as epoxy resin wall panels, epoxy resin wall panels, and epoxy resin wall panels.



1. **Sealing and Grouting:** Epoxy resin is used to seal the joints between tiles, preventing water and dirt from penetrating. It also provides a strong, durable bond between the tiles and the substrate.

- Gray 1#
- Gray 2#
- Gray 3#
- Gray 4#
- Gray 5#
- Gray 6#
- Gray 7#
- Gray 8#
- Gray 9#
- Cement Gray
- Dull Gray
- Silver Gray
- Metal Gray
- Luxury Silver
- Glacier White
- Calaeatta
- Pearl Gold
- Slate Gray
- Terra Brown
- Greyish Green
- Yellow Gray
- Soft Khaki
- Yellowish Brown
- Olive Brown
- Brownness
- Dark Brown
- Reddish Brown
- Rock Bslack

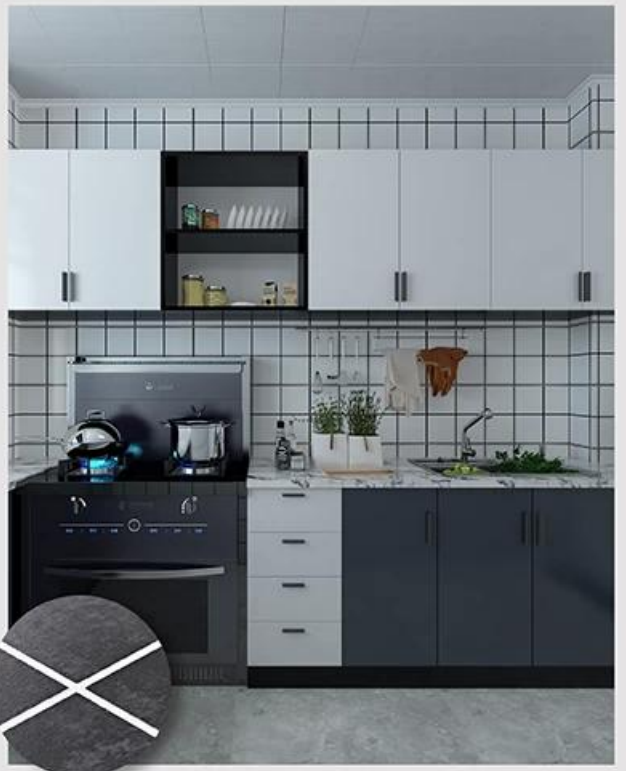

□□□□□□ □□□□ □□ □□□□□□ □□□□□□ □□□□

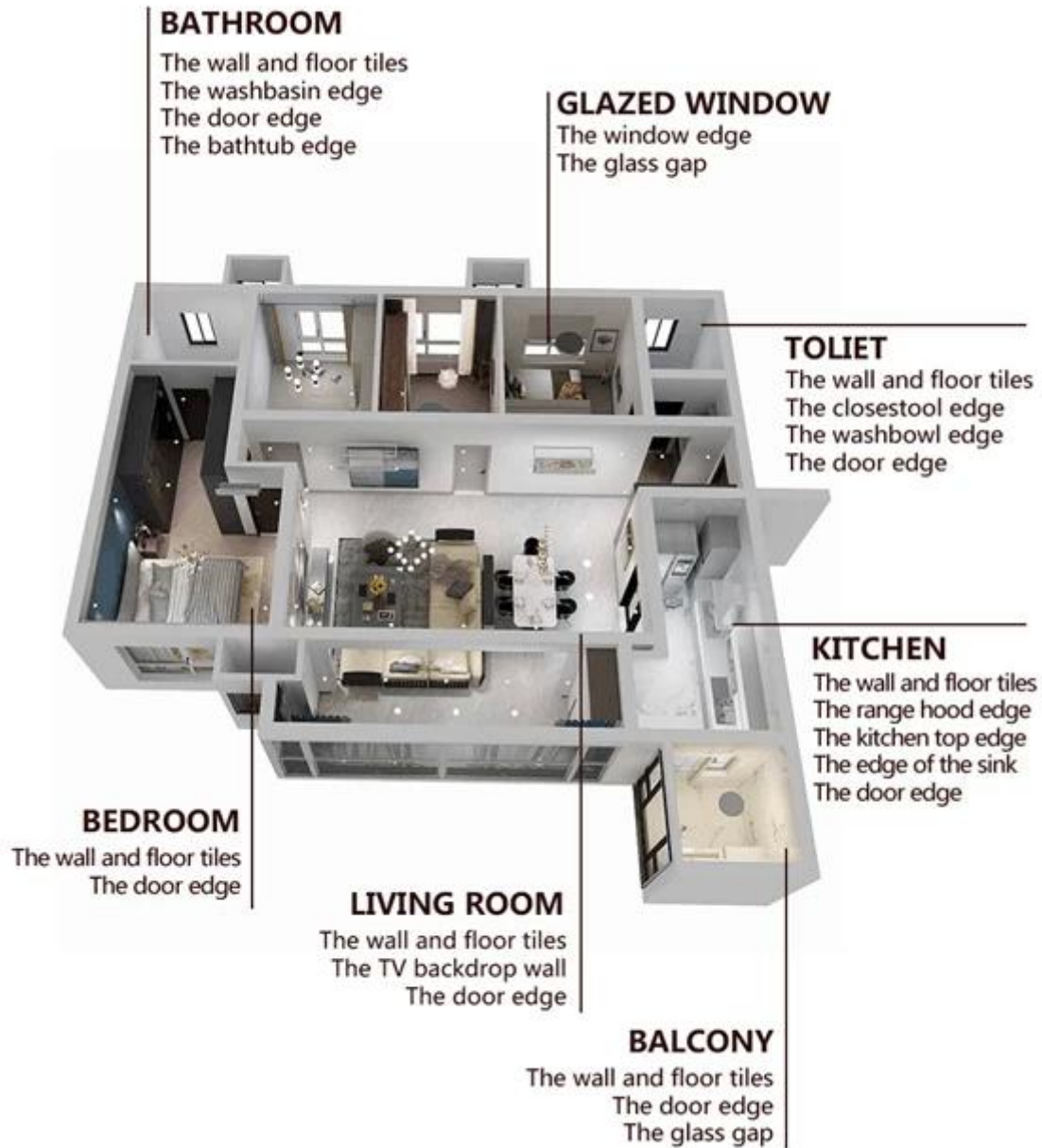

□□□□□□□□ □□□□□□ □□□□□□□□



Clean the tiles and keep it dry



Polish with tile wax except the glazed tile



Open & Watch, both sides can extruded meanwhile



Screw on the nozzle, put on the grout gun



Inclined cut the top of the nozzle in 45°



Squeeze out 60-80cm long grout in the forepart

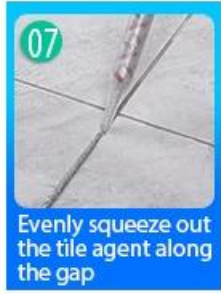

Evenly squeeze out the tile agent along the gap

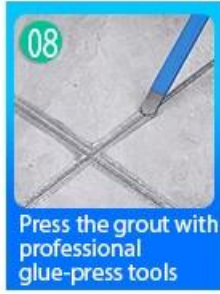

Press the grout with professional glue-press tools



Don't touch in 4-5 hours and remove excess grout then.

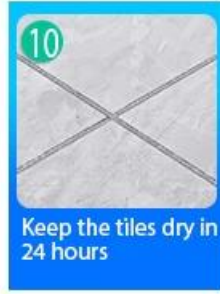

Keep the tiles dry in 24 hours

□□□□□ □□□□□□□ □□□□ □□□□ □□□□□



Two Component Caulking Gun

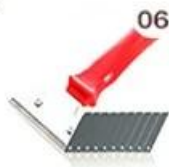

Cutter Knife

Pointing trowel

Brush

Forming Stick

Perching Knife

Masking Tape

Stainless Steel Ball

Cleaning Awl

□□□□ □□ □□□□□



XXXXXXXXXX XXXXXXXX



XXXXXXXXXX XXXXXXXX



XXXXXXXXXX XXXXXXXX



XXXXXXXXXX XXXXXXXX XXXXXXXX



XXXXXXXXXX XXXXXXXX



XXXXXXXXXX XXXXXXXX



XXXXXXXXXX-XXXXXXXXXX XXXXXXXX



XXXXXXXXXX XXXXXXXX XXXXXXXX XXXXXXXX



XXXXXXXXXX

XXXXXXXXXXXXXXXXXX

