

1. **Introduction**
 2. **Product Description**
 3. **Applications**
 4. **Advantages**
 5. **Installation**
 6. **Maintenance**
 7. **Conclusion**



1. **Introduction**
 2. **Product Description**
 3. **Applications**
 4. **Advantages**
 5. **Installation**
 6. **Maintenance**
 7. **Conclusion**



□□□□□□ □□□□ □□ □□□□□□ □□□□□□ □□□□

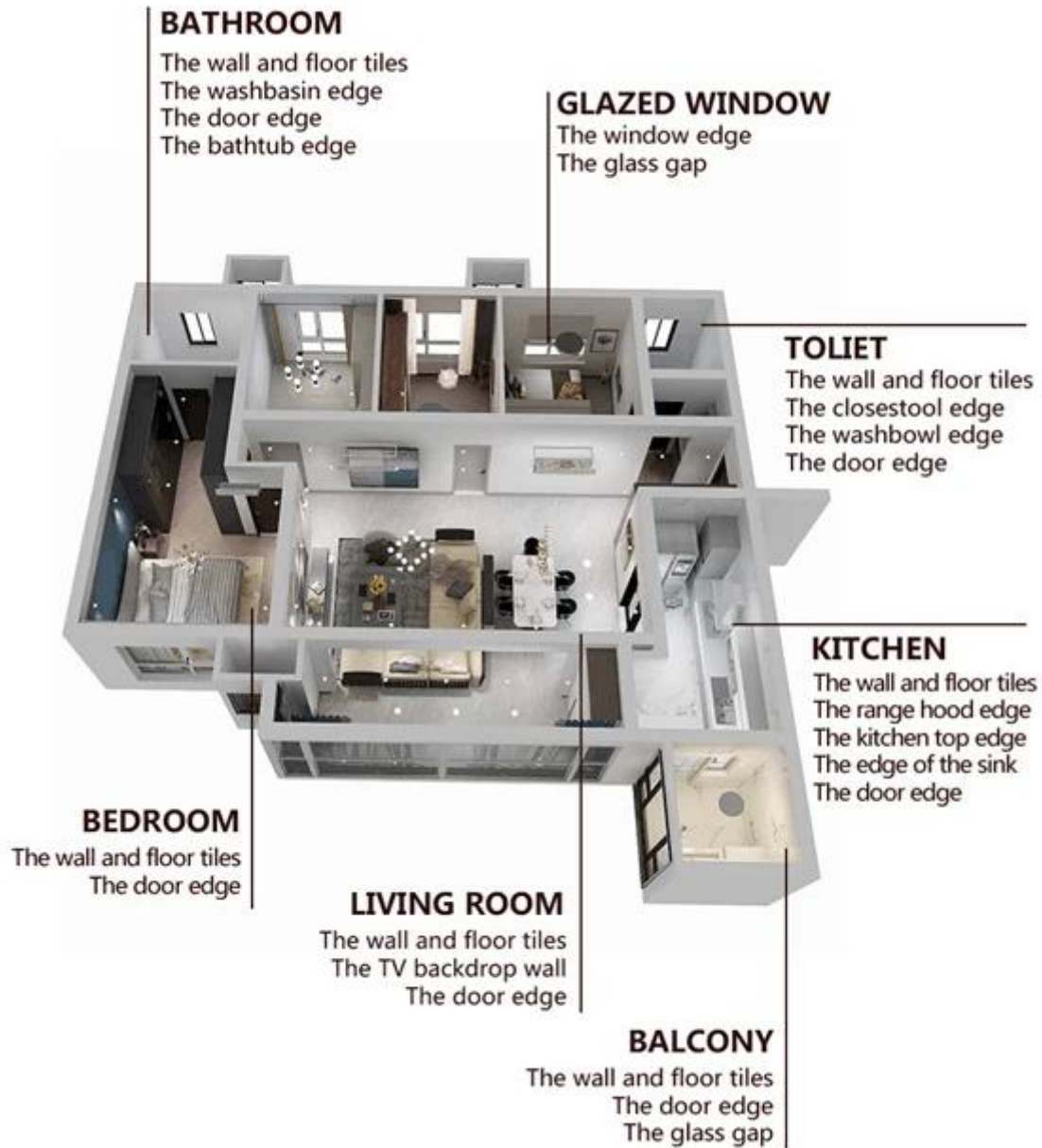

□□□□□□□□ □□□□□□ □□□□□□□□

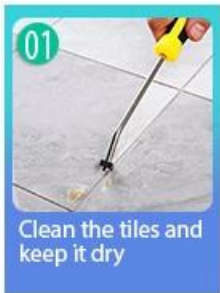

01
Clean the tiles and keep it dry



02
Polish with tile wax except the glazed tile

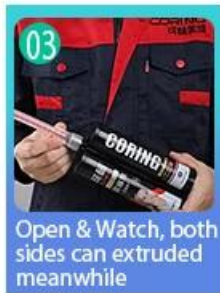

03
Open & Watch, both sides can extruded meanwhile

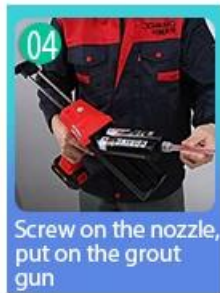

04
Screw on the nozzle, put on the grout gun



05
Inclined cut the top of the nozzle in 45°



06
Squeeze out 60-80cm long grout in the forefront



07
Evenly squeeze out the tile agent along the gap



08
Press the grout with professional glue-press tools



09
Don't touch in 4-5 hours and remove excess grout then.

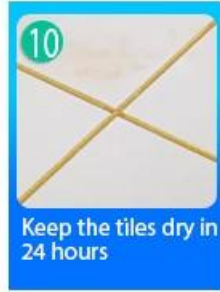

10
Keep the tiles dry in 24 hours

□□□□□ □□□□□□□ □□□□ □□□□ □□□□□



Two Component Caulking Gun



02
Cutter Knife



03
Pointing trowel



04
Brush



05
Forming Stick



06
Perching Knife



07
Masking Tape



08
Stainless Steel Ball



09
Cleaning Awl

□□□□ □□ □□□□□



XXXXXXXXXX XXXXXXXX



XXXXXXXXXX XXXXXXXX



XXXXXXXXXX XXXXXXXX



XXXXXXXXXX XXXXXXXX XXXXXXXX



XXXXXXXXXX XXXXXXXX



XXXXXXXXXX XXXXXXXX



XXXXXXXXXX-XXXXXXXXXX XXXXXXXX

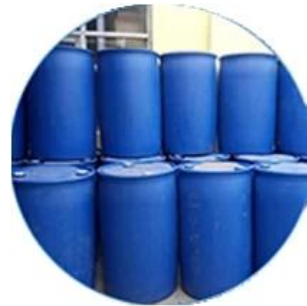

XXXXXXXXXX XXXXXXXX XXXXXXXX XXXXXXXX



XXXXXXXXXX

XXXXXXXXXXXXXXXXXX

