

POLYUREA 14

14



POLYUREA 14

- Gray 1#
- Gray 2#
- Gray 3#
- Gray 4#
- Gray 5#
- Gray 6#
- Gray 7#
- Gray 8#
- Gray 9#
- Cement Gray
- Dull Gray
- Silver Gray
- Metal Gray
- Luxury Silver
- Glacier White
- Calaeatta
- Pearl Gold
- Slate Gray
- Terra Brown
- Greyish Green
- Yellow Gray
- Soft Khaki
- Yellowish Brown
- Olive Brown
- Brownness
- Dark Brown
- Reddish Brown
- Rock Bslack



□□□□□□ □□□□ □□ □□□□□□ □□□□□□ □□□□

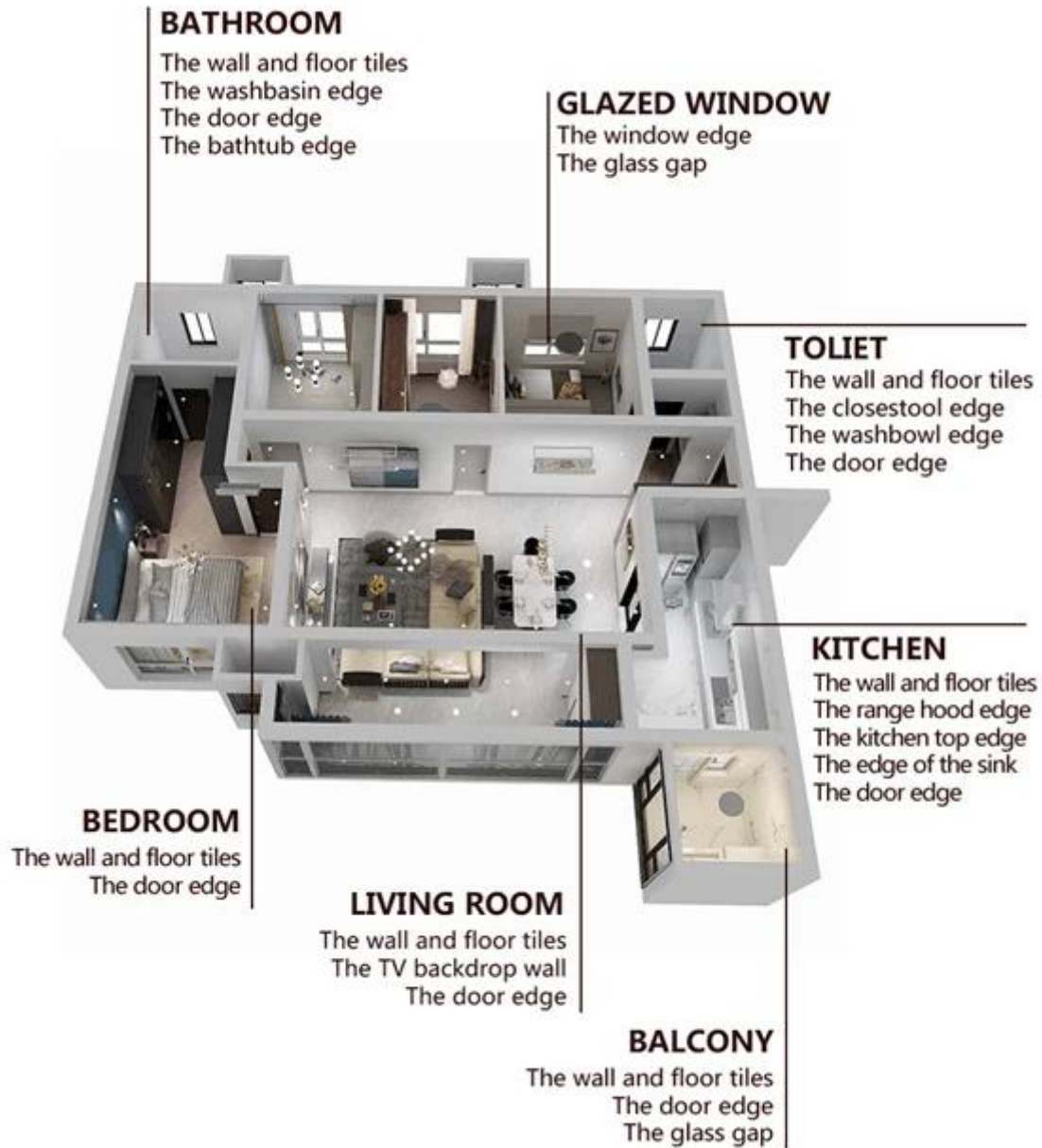

□□□□□□□□ □□□□□□ □□□□□□□□





01

Clean the tiles and keep it dry



02

Polish with tile wax except the glazed tile

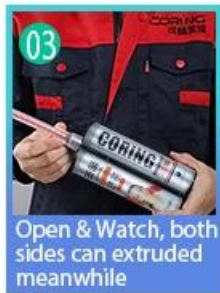

03

Open & Watch, both sides can extruded meanwhile



04

Screw on the nozzle, put on the grout gun



05

Inclined cut the top of the nozzle in 45°



06

Squeeze out 60-80cm long grout in the forepart

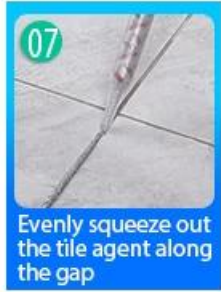

07

Evenly squeeze out the tile agent along the gap



08

Press the grout with professional glue-press tools



09

Don't touch in 4-5 hours and remove excess grout then.

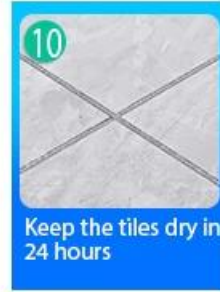

10

Keep the tiles dry in 24 hours

□□□□□□□□ □□□□□□-□□□□ □□ □□□□



Two Component Caulking Gun



02



03



04



05



06



07



08



09

Cutter Knife

Pointing trowel

Brush

Forming Stick

Perching Knife

Masking Tape

Stainless Steel Ball

Cleaning Awl

□□□□ □□



□□□□□□ □□□□□□



Creaming Machine Line



Testing Machine



Batching Production Line



Cooling Filling



Filling Machine Line



Film-coated Machine



Real Material Stock



Stock

□□□□□□□□□□

