

The text in this block is extremely faint and illegible, appearing as a series of light gray lines. It likely contains introductory information about the product or company.

The text in this block is also extremely faint and illegible, continuing the introductory information.



The text in this block is extremely faint and illegible, likely serving as a footer or contact information.

- Gray 1#
- Gray 2#
- Gray 3#
- Gray 4#
- Gray 5#
- Gray 6#
- Gray 7#
- Gray 8#
- Gray 9#
- Cement Gray
- Dull Gray
- Silver Gray
- Metal Gray
- Luxury Silver
- Glacier White
- Calaeatta
- Pearl Gold
- Slate Gray
- Terra Brown
- Greyish Green
- Yellow Gray
- Soft Khaki
- Yellowish Brown
- Olive Brown
- Brownness
- Dark Brown
- Reddish Brown
- Rock Bslack



□□□□□□ □□□□ □□ □□□□□□ □□□□□□ □□□□

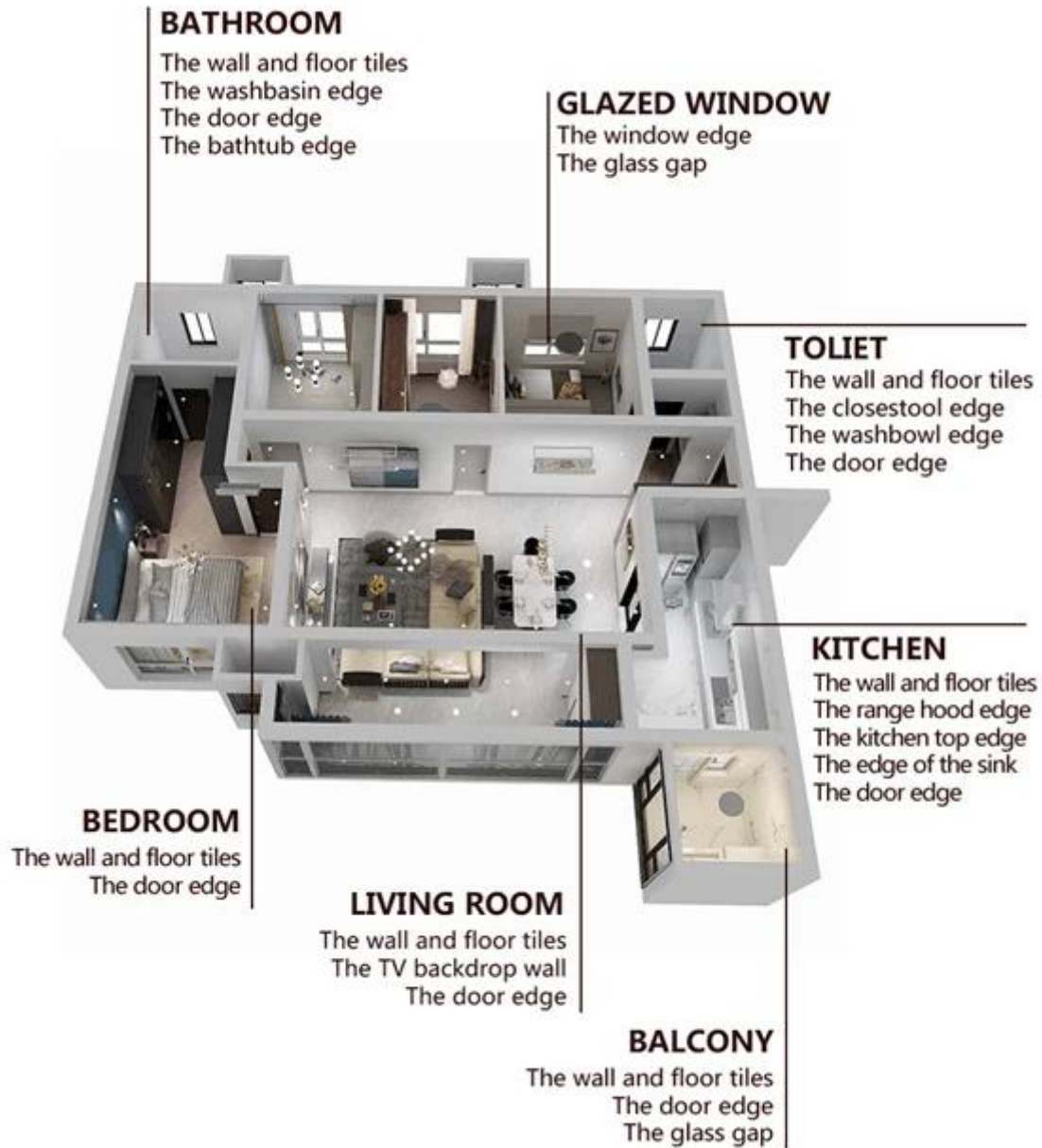

□□□□□□□□ □□□□□□ □□□□□□□□





01

Clean the tiles and keep it dry



02

Polish with tile wax except the glazed tile

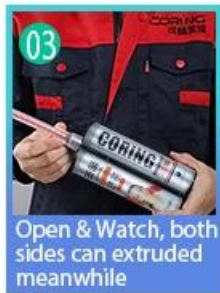

03

Open & Watch, both sides can extruded meanwhile



04

Screw on the nozzle, put on the grout gun



05

Inclined cut the top of the nozzle in 45°



06

Squeeze out 60-80cm long grout in the forepart

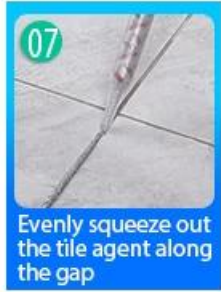

07

Evenly squeeze out the tile agent along the gap



08

Press the grout with professional glue-press tools



09

Don't touch in 4-5 hours and remove excess grout then.

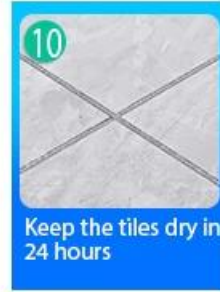

10

Keep the tiles dry in 24 hours

□□□□□ □□□□□□□□-□□□□□ □□ □□□□□



Two Component Caulking Gun



02



03



04



05



06



07



08



09

Cutter Knife

Pointing trowel

Brush

Forming Stick

Pointing Knife

Masking Tape

Stainless Steel Ball

Cleaning Awl

□□□□□ □□□



□□□□□□ □□□□□□



Creaming Machine Line



Testing Machine



Batching Production Line



Cooling Filling



Filling Machine Line



Film-coated Machine



Real Material Stock



Stock

□□□□□□□□□□

