

1. **Highly resistant to water** - Epoxy resin is highly resistant to water, which makes it ideal for use in wet areas such as bathrooms, kitchens, and swimming pools.

2. **Highly resistant to chemicals** - Epoxy resin is highly resistant to a wide range of chemicals, including acids, alkalis, and solvents.



3. **Highly resistant to abrasion** - Epoxy resin is highly resistant to wear and tear, making it ideal for use in high-traffic areas.

Gray 1#

Gray 2#

Gray 3#

Gray 4#

Gray 5#

Gray 6#

Gray 7#

Gray 8#

Gray 9#

Cement Gray

Dull Gray

Silver Gray

Metal Gray

Luxury Silver

Glacier White

Calaeatta

Pearl Gold

Slate Gray

Terra Brown

Greyish Green

Yellow Gray

Soft Khaki

Yellowish Brown

Olive Brown

Brownness

Dark Brown

Reddish Brown

Rock Bslack



□□□□ □□□□ □□ □□□□□□ □□□□□□ □□□□□□ □□□□□

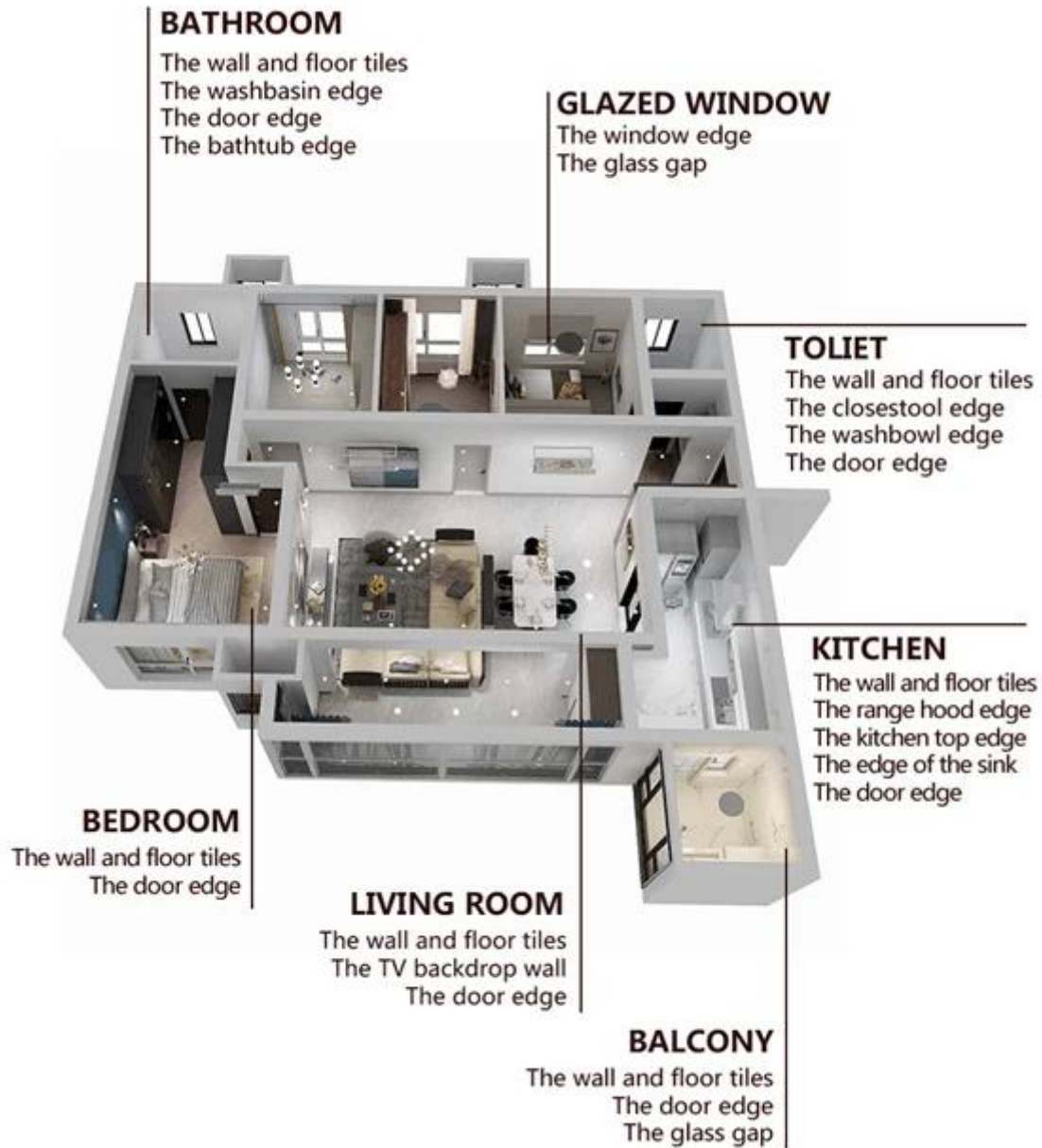

□□□□□□□□ □□□□□□ □□□□□□□□



01 Clean the tiles and keep it dry



02 Polish with tile wax except the glazed tile



03 Open & Watch, both sides can extruded meanwhile



04 Screw on the nozzle, put on the grout gun



05 Inclined cut the top of the nozzle in 45°



06 Squeeze out 60-80cm long grout in the forepart



07 Evenly squeeze out the tile agent along the gap



08 Press the grout with professional glue-press tools



09 Don't touch in 4-5 hours and remove excess grout then.



10 Keep the tiles dry in 24 hours

□□□□□□□□ □□□□□□ □□□ □□□□□



Two Component Caulking Gun



Cutter Knife

Pointing trowel

Brush

Forming Stick

Perching Knife

Masking Tape

Stainless Steel Ball

Cleaning Awl

□□□□□ □□□



□□□□□□ □□□□□□



Creaming Machine Line



Testing Machine



Batching Production Line



Cooling Filling



Filling Machine Line



Film-coated Machine



Real Material Stock



Stock

□□□□□□□□□□

