

1. **Application Areas:** The product is suitable for use in various areas, including:

- Toilets:** For wall and floor applications.
- Corner:** For reinforcing and finishing corners.
- Edge of bath:** For sealing and finishing the edges of bathtubs.
- Mosaic tile:** For creating decorative mosaic patterns.
- Floor tile:** For creating durable and smooth floor surfaces.
- Kitchen:** For wall and countertop applications.
- Ceramic tile:** For creating smooth and durable ceramic tile surfaces.
- Skirting line:** For creating decorative and protective skirting lines.

2. **Application Method:** The product is applied using a brush or roller. It is recommended to use a **Epoxy Primer** before application. The application should be done in a thin layer, and the surface should be allowed to dry for **14** days before use. For more information, please refer to the **Technical Data Sheet** and **Application Manual**.



3. **Product Features:** The product offers several key benefits:

- High Adhesion:** Ensures a strong bond to various substrates.
- Waterproofing:** Provides excellent resistance to moisture and water.
- Chemical Resistance:** Resistant to acids, alkalis, and other chemicals.
- Easy Maintenance:** The finished surface is smooth and easy to clean.
- Long-lasting:** Provides a durable and long-lasting finish.

- Gray 1#
- Gray 2#
- Gray 3#
- Gray 4#
- Gray 5#
- Gray 6#
- Gray 7#
- Gray 8#
- Gray 9#
- Cement Gray
- Dull Gray
- Silver Gray
- Metal Gray
- Luxury Silver
- Glacier White
- Calaeatta
- Pearl Gold
- Slate Gray
- Terra Brown
- Greyish Green
- Yellow Gray
- Soft Khaki
- Yellowish Brown
- Olive Brown
- Brownness
- Dark Brown
- Reddish Brown
- Rock Bslack

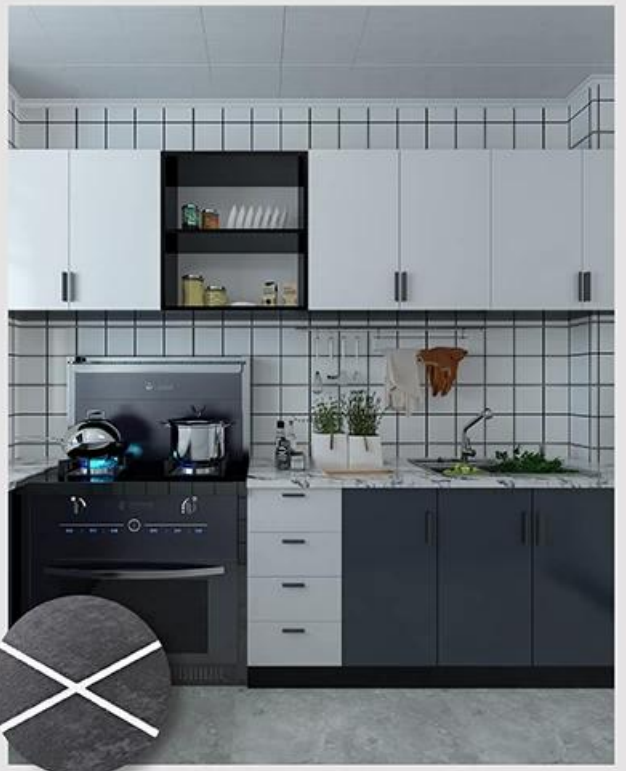

□□□□ □□□□ □□ □□□□□□ □□□□□□ □□□□□□ □□□□□

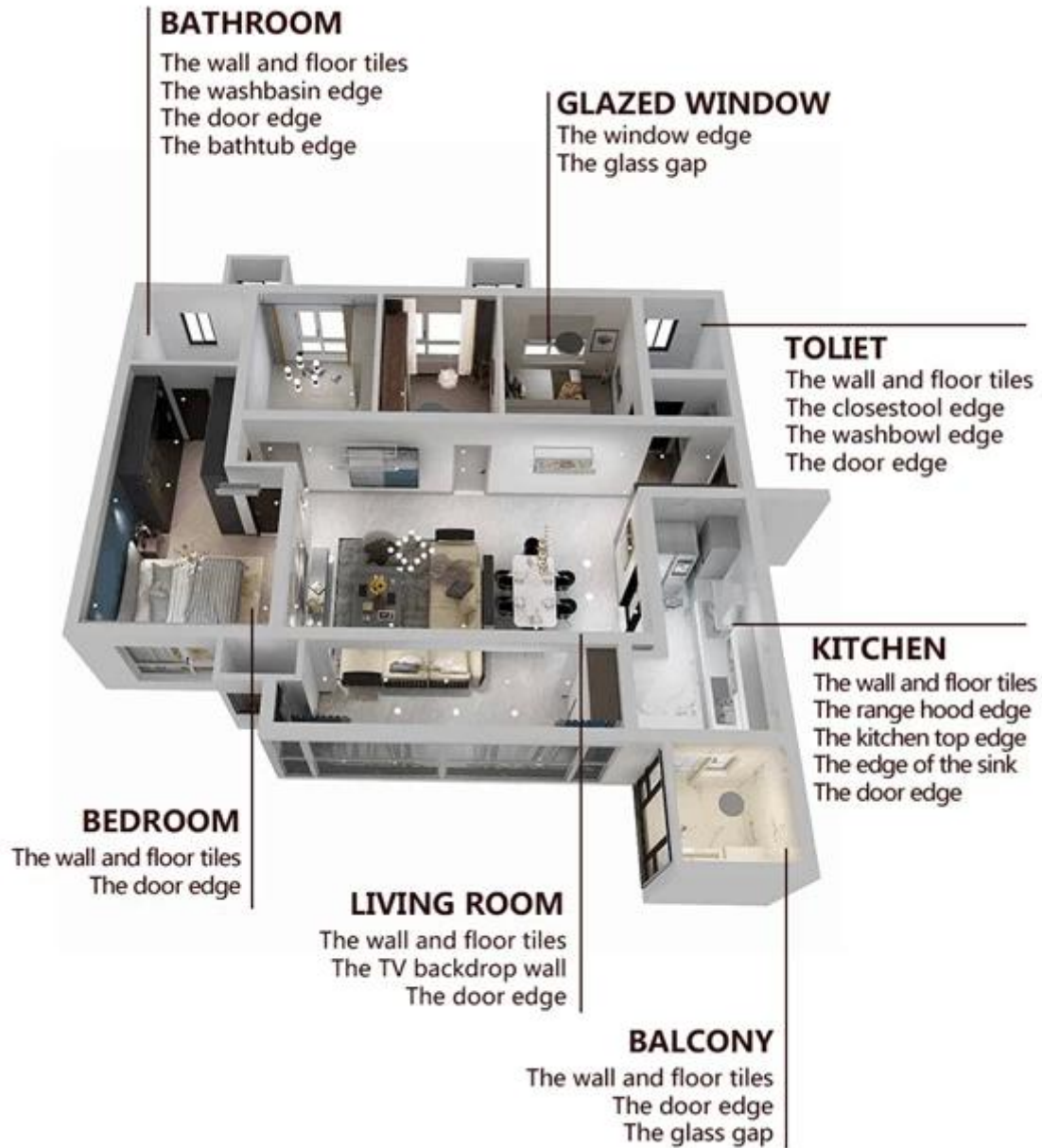

□□□□□□□□ □□□□□□ □□□□□□□□



01 Clean the tiles and keep it dry



02 Polish with tile wax except the glazed tile



03 Open & Watch, both sides can extruded meanwhile



04 Screw on the nozzle, put on the grout gun



05 Inclined cut the top of the nozzle in 45°



06 Squeeze out 60-80cm long grout in the forepart



07 Evenly squeeze out the tile agent along the gap



08 Press the grout with professional glue-press tools



09 Don't touch in 4-5 hours and remove excess grout then.



10 Keep the tiles dry in 24 hours

□□□□□□□□ □□□□□□-□□□□ □□□ □□□□□



Two Component Caulking Gun



02 Cutter Knife



03 Pointing trowel



04 Brush



05 Forming Stick



06 Pointing Knife



07 Masking Tape



08 Stainless Steel Ball



09 Cleaning Awl

□□□□ □□



□□□□□□ □□□□□□



Creaming Machine Line



Testing Machine



Batching Production Line



Cooling Filling



Filling Machine Line



Film-coated Machine



Real Material Stock



Stock

□□□□□□□□□□

