

1. **High Quality**: The tiles are made from high-quality raw materials and are fired at high temperatures, ensuring durability and resistance to wear and tear.

2. **Wide Application**: The tiles are suitable for various applications, including:

- Toilets**: Ideal for bathroom walls and floors.
- Corner**: Perfect for protecting sharp corners in high-traffic areas.
- Edge of bath**: Suitable for the edges of bathtubs and showers.
- Skirting line**: Ideal for protecting the base of walls from damage.
- Ceramic tile**: Suitable for kitchen walls and backsplashes.
- Floor tile**: Ideal for living rooms, hallways, and bedrooms.
- Mosaic tile**: Perfect for decorative wall and floor applications.
- Kitchen**: Suitable for kitchen walls and backsplashes.

3. **Easy Maintenance**: The tiles are easy to clean and maintain, making them a practical choice for busy households.

4. **Wide Range of Colors and Patterns**: The tiles are available in a wide range of colors and patterns, allowing you to choose the perfect look for your space.

5. **Long-Lasting**: The tiles are designed to last for many years, providing a long-term investment in your home's appearance.



1. **choice** is a great choice for your home. It is a high-quality, durable, and easy-to-maintain material that is suitable for a wide range of applications.



- Pure White
- Ivory
- Lemon Gold
- Pearl Gold
- Light Gold
- Lime Gold
- Amber Gold
- Nobility Gold
- Luxury Gold
- Shiny Gold
- Dazzle Gold
- Moonlight Silver
- Shiny Silver
- Dazzle Silver
- Light Gray
- Noble Gray
- Silver Gray
- Champaign Gold
- Bronze
- Rose Gold
- Coffee Brown
- Black Pearl

□□□□□□ □□□□ □□ □□□□□□ □□□□□□ □□□□

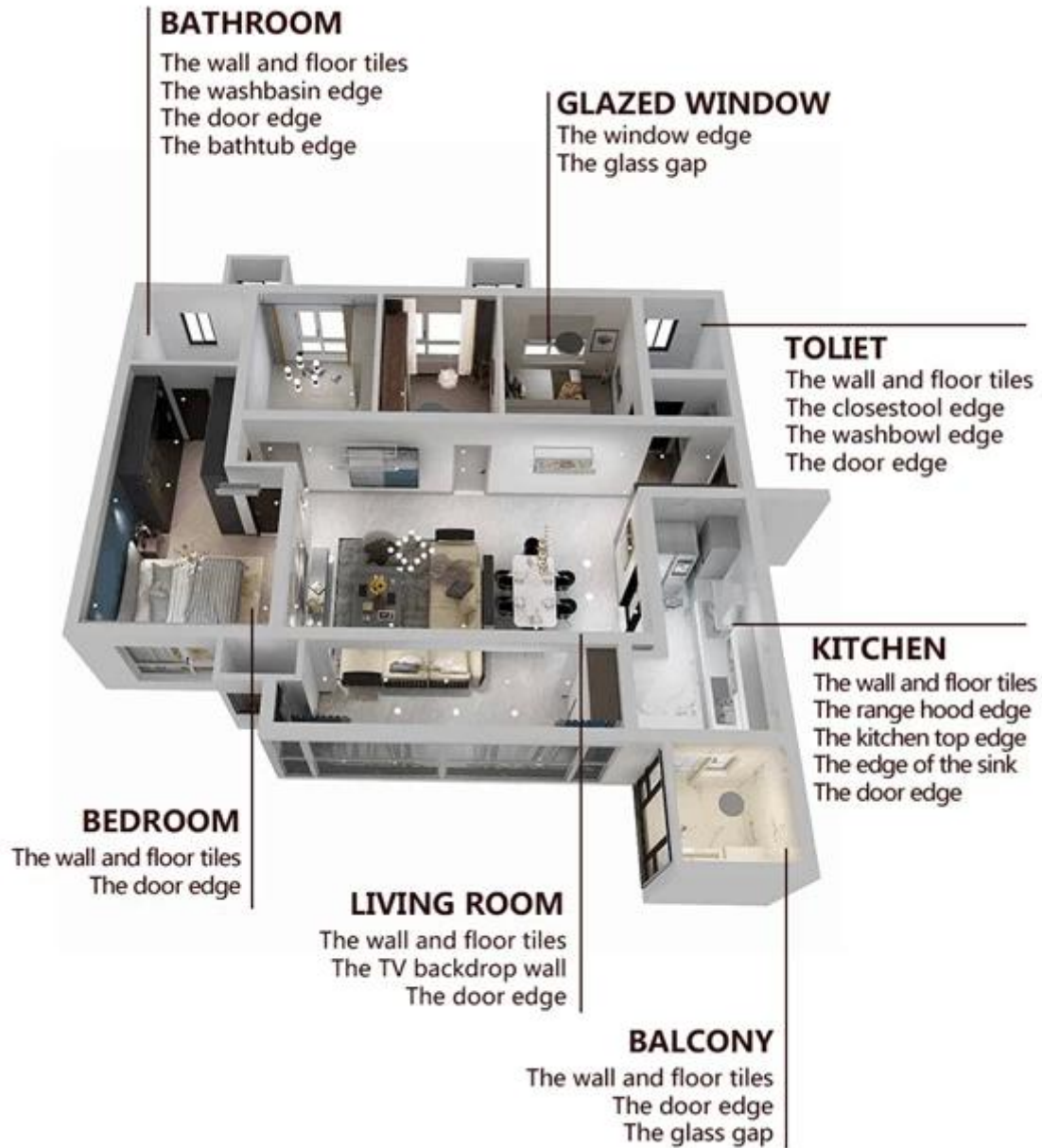

□□□□□□□□ □□□□□□ □□□□□□□□



01
Clean the tiles and keep it dry



02
Polish with tile wax except the glazed tile

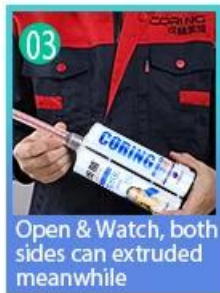

03
Open & Watch, both sides can extruded meanwhile

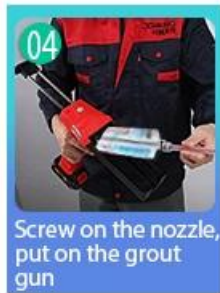

04
Screw on the nozzle, put on the grout gun



05
Inclined cut the top of the nozzle in 45°



06
Squeeze out 60-80cm long grout in the forepart



07
Evenly squeeze out the tile agent along the gap

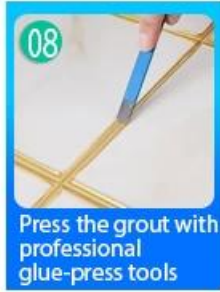

08
Press the grout with professional glue-press tools



09
Don't touch in 4-5 hours and remove excess grout then.

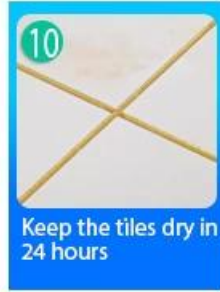

10
Keep the tiles dry in 24 hours

□□□□□ □□□□□□ □□□□ □□□□ □□□□□



Two Component Caulking Gun



Cutter Knife

Pointing trowel

Brush

Forming Stick

Perching Knife

Masking Tape

Stainless Steel Ball

Cleaning Awl

□□□□ □□ □□□□□

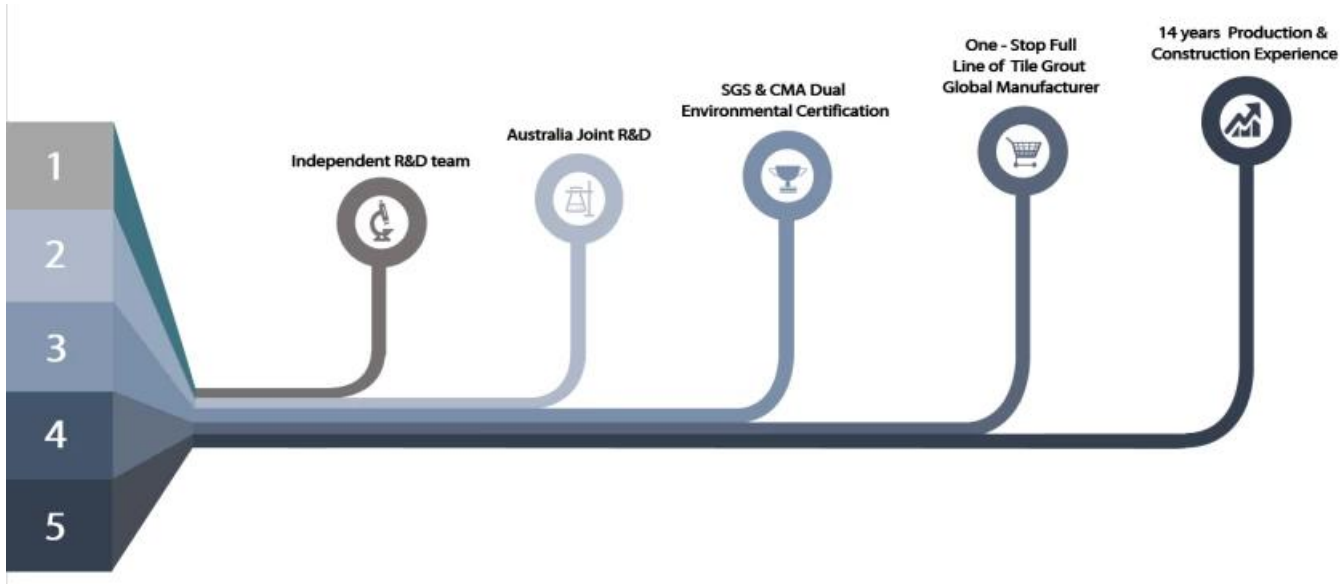

XXXXXXXXXX XXXXXXXX



XXXXXXXXXX XXXXXXXX



XXXXXXXXXX XXXXXXXX



XXXXXXXXXX XXXXXXXX



XXXXXXXXXX XXXXXXXX



XXXXXXXXXX XXXXXXXX



XXXXXXXXXX XXXXXXXX



XXXXXXXXXX XXXXXXXX



XXXXXXXXXX XXXXXXXX

XXXXXXXXXX XXXXXXXX

