

1. **High Quality**: The tiles are made from high-quality raw materials and are fired at high temperatures, ensuring durability and resistance to wear and tear.

2. **Wide Application**: The tiles are suitable for use in various areas, including walls, floors, and ceilings. They are also suitable for use in high-traffic areas and outdoor spaces.

3. **Easy Maintenance**: The tiles are easy to clean and maintain. They are resistant to stains and discoloration, and they do not require special cleaning products.

4. **Wide Choice**: The tiles are available in a wide range of colors, patterns, and finishes, allowing you to choose the perfect tile for your space.

5. **Long Lasting**: The tiles are designed to last for many years, providing a long-term solution for your tiling needs.



1. **choice** is a key factor in selecting the right tile for your project.



- Pure White
- Ivory
- Lemon Gold
- Pearl Gold
- Light Gold
- Lime Gold
- Amber Gold
- Nobility Gold
- Luxury Gold
- Shiny Gold
- Dazzle Gold
- Moonlight Silver
- Shiny Silver
- Dazzle Silver
- Light Gray
- Noble Gray
- Silver Gray
- Champaign Gold
- Bronze
- Rose Gold
- Coffee Brown
- Black Pearl

□□□□□□ □□□□ □□ □□□□□□ □□□□□□ □□□□

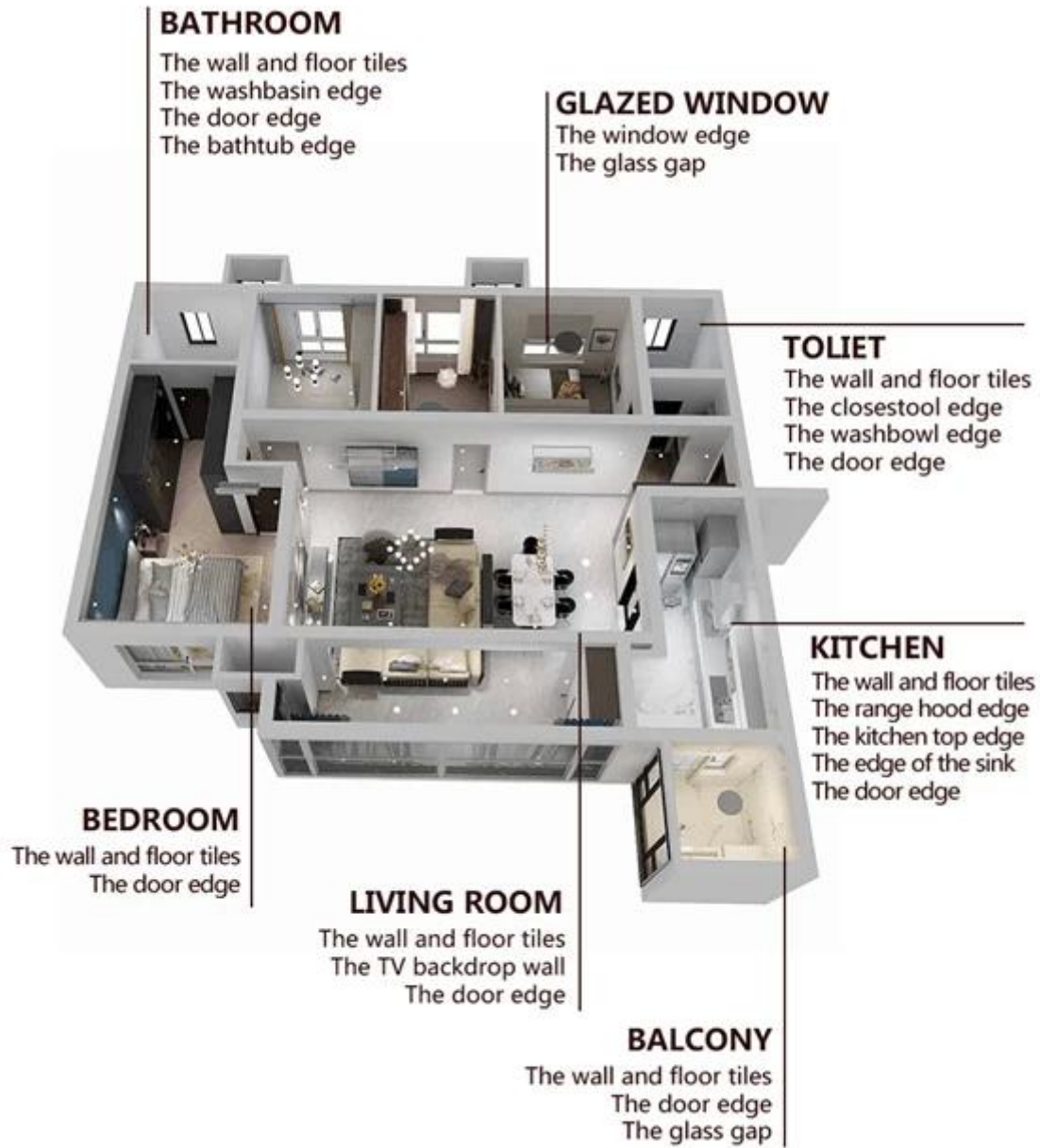

□□□□□□□□ □□□□□□ □□□□□□□□



Clean the tiles and keep it dry



Polish with tile wax except the glazed tile

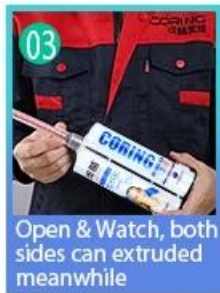

Open & Watch, both sides can extruded meanwhile

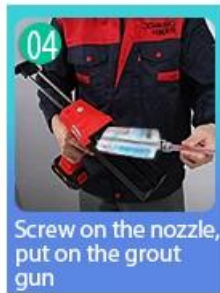

Screw on the nozzle, put on the grout gun



Inclined cut the top of the nozzle in 45°



Squeeze out 60-80cm long grout in the forepart



Evenly squeeze out the tile agent along the gap

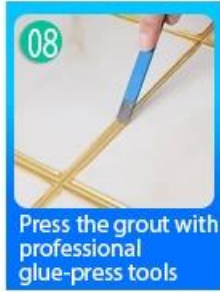

Press the grout with professional glue-press tools



Don't touch in 4-5 hours and remove excess grout then.

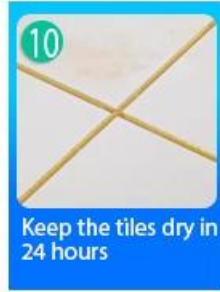

Keep the tiles dry in 24 hours

□□□□□ □□□□□□□ □□□□ □□□□ □□□□□



Two Component Caulking Gun



Cutter Knife

Pointing trowel

Brush

Forming Stick

Perching Knife

Masking Tape

Stainless Steel Ball

Cleaning Awl

□□□□ □□ □□□□□

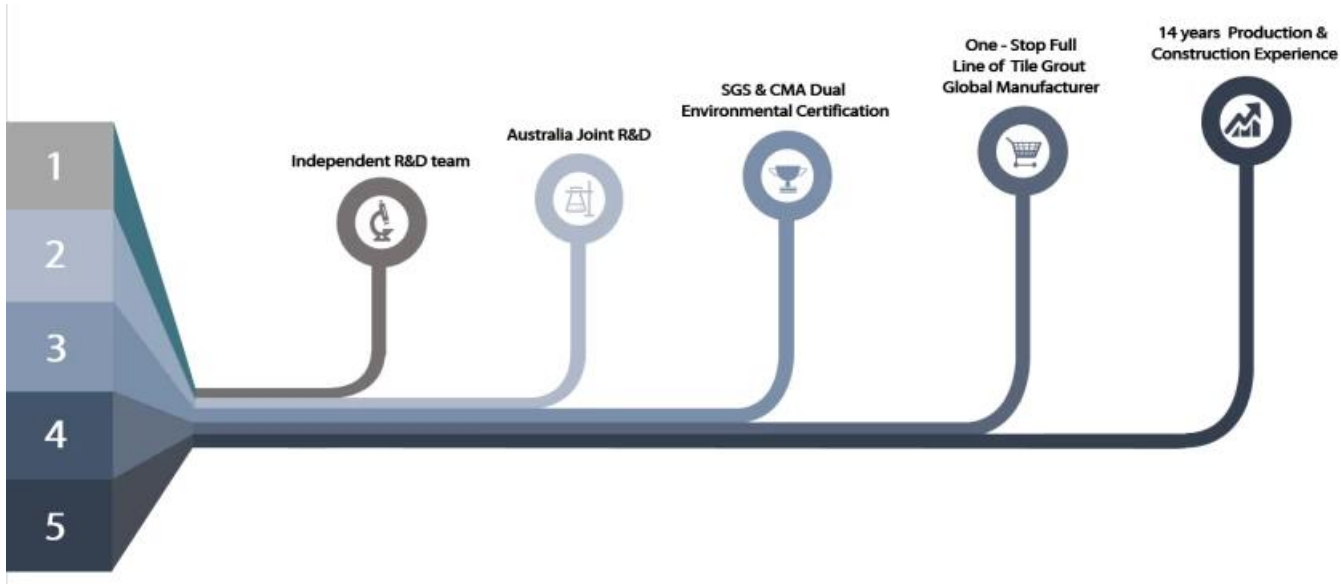

XXXXXXXXXX XXXXXXXX



XXXXXXXXXX XXXXXXXX



XXXXXXXXXX XXXXXXXX



XXXXXXXXXX XXXXXXXX



XXXXXXXXXX XXXXXXXX



XXXXXXXXXX XXXXXXXX



XXXXXXXXXX XXXXXXXX



XXXXXXXXXX XXXXXXXX



XXXXXXXXXX XXXXXXXX

XXXXXXXXXX XXXXXXXX

