

epoxy resin is a two-part system consisting of a resin and a hardener. When mixed together, they undergo a chemical reaction to form a solid, durable material. This material is used in a wide range of applications, including:

- **Construction:** Used for floor coatings, wall treatments, and repair of concrete surfaces.
- **Automotive:** Used for repairing and restoring car bodies and parts.
- **Marine:** Used for boat repairs, hull coatings, and deck treatments.
- **Art and Design:** Used for creating decorative surfaces, sculptures, and jewelry.
- **Industrial:** Used for bonding, coating, and repairing machinery and equipment.

The epoxy resin is known for its high strength, durability, and resistance to chemicals and abrasion. It is also available in a variety of colors and finishes, making it a popular choice for decorative applications.



epoxy resin is a two-part system consisting of a resin and a hardener. When mixed together, they undergo a chemical reaction to form a solid, durable material. This material is used in a wide range of applications, including:



- Pure White
- Ivory
- Lemon Gold
- Pearl Gold
- Light Gold
- Lime Gold
- Amber Gold
- Nobility Gold
- Luxury Gold
- Shiny Gold
- Dazzle Gold
- Moonlight Silver
- Shiny Silver
- Dazzle Silver
- Light Gray
- Noble Gray
- Silver Gray
- Champaign Gold
- Bronze
- Rose Gold
- Coffee Brown
- Black Pearl

□□□□ □□□□ □□ □□□□□□ □□□□□□ □□□□□□ □□□□

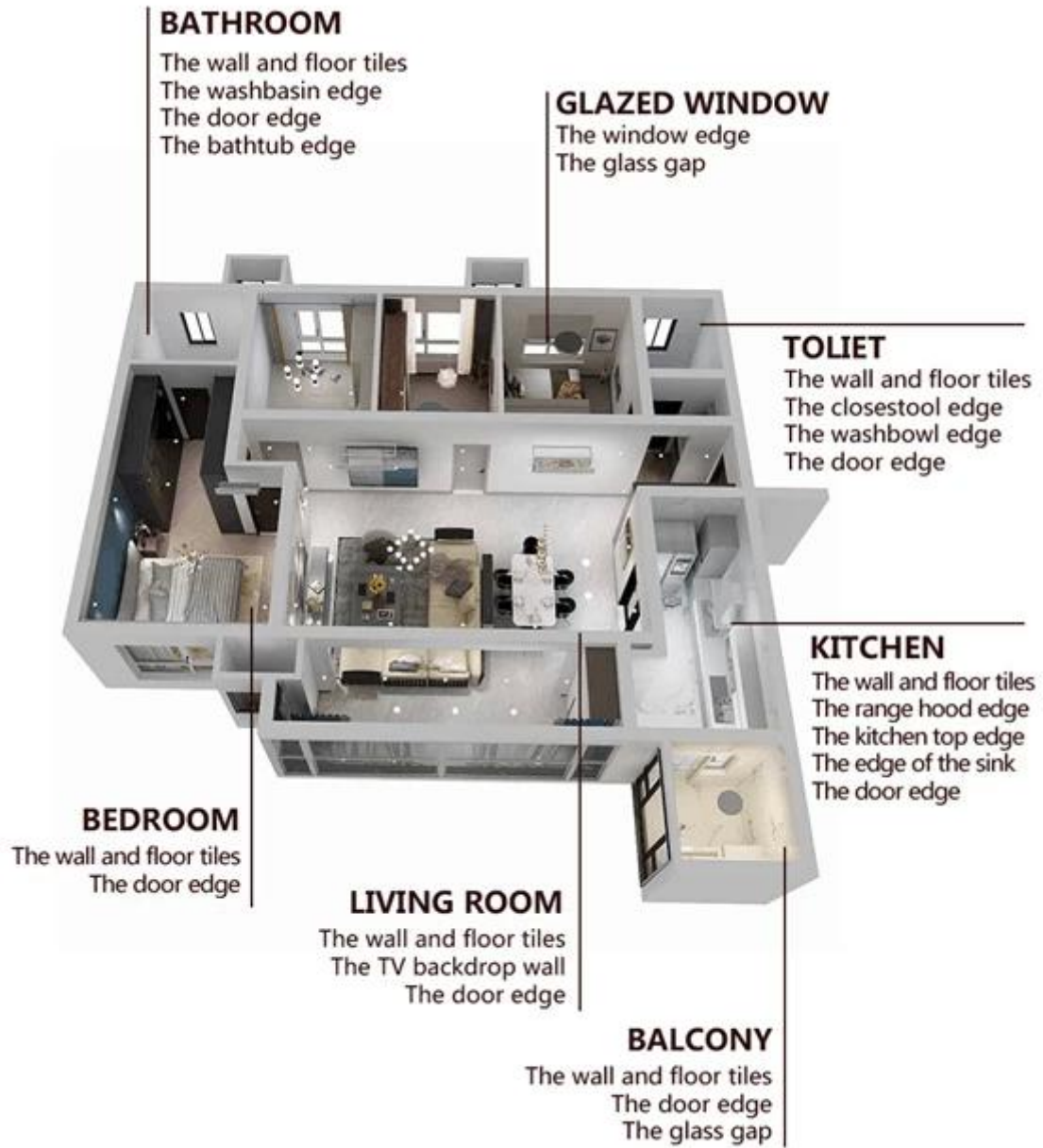

如何進行瓷磚美縫



01 將美縫膏填入瓷磚縫隙中



02 用美縫膏浮筒將美縫膏抹平



03 將美縫膏填入牆面瓷磚縫隙中



04 將美縫膏填入牆面瓷磚縫隙中，grout



05 將美縫膏填入牆面瓷磚縫隙中，45度角



Forepart 60-80 grout



Apply grout to the joint



Smooth the grout



Clean the joint



Final result

Two Component Caulking Gun



Two Component Caulking Gun



Cutter Knife



Pointing trowel



Brush



Forming Stick

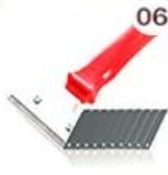

Perching Knife



Masking Tape



Stainless Steel Ball



Cleaning Awl

Additional tools



XXXXXXXXXX XXXXXXXX



XXXXXXXXXX XXXXXXXX



XXXXXXXXXX XXXXXXXX



XXXXXXXXXX XXXXXXXX



XXXXXXXXXX XXXXXXXX



XXXXXXXXXX XXXXXXXX



XXXXXXXXXX XXXXXXXX



XXXXXXXXXX XXXXXXXX



XXXXXXXXXX XXXXXXXX

XXXXXXXXXXXXXX

